



*George Hall Elementary School*

A Kind and Inclusive School Community

130 San Miguel Way, San Mateo, CA 94403

Phone (650)312-7533

<http://george-hall.smfcsd.net/>

Directions to confirm your  
learning model selection in the  
Aeries Parent Portal

# San Mateo-Foster City School District



If you are already in the Aeries Parent Portal, please log out and then please sign back in

In order to receive the most updated version of Aeries, you must approve an update.



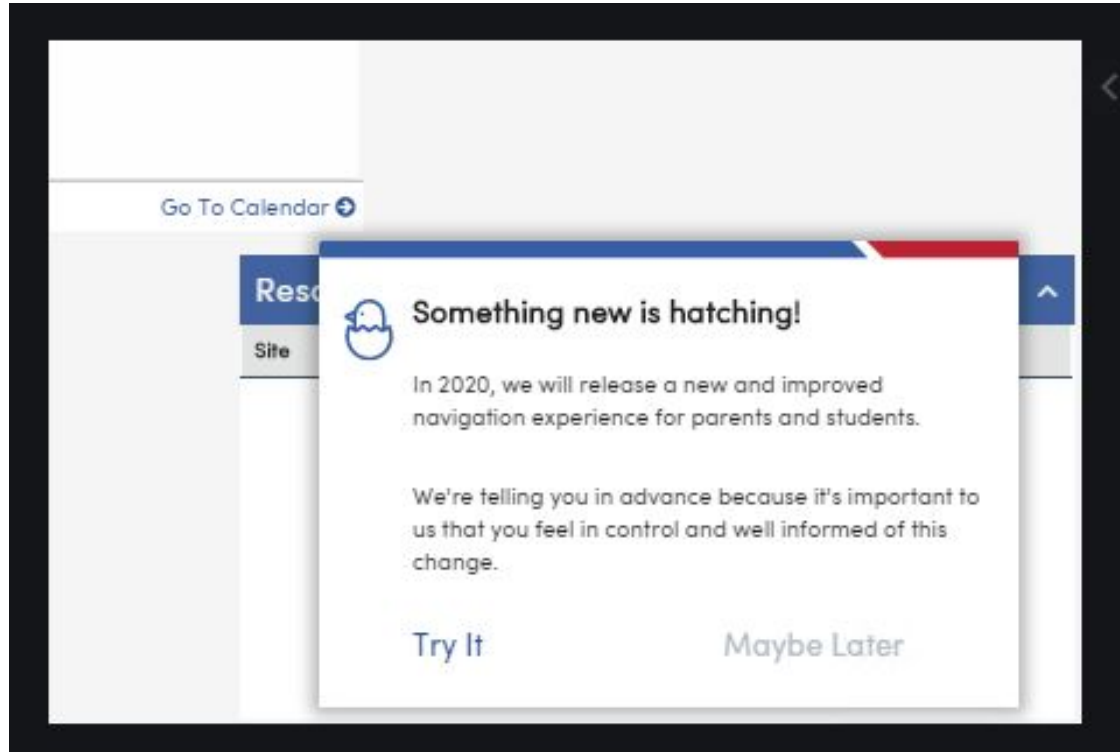

You will see a pop-up on the bottom right asking you to try a new version of Aeries. Please click on “Try It.”

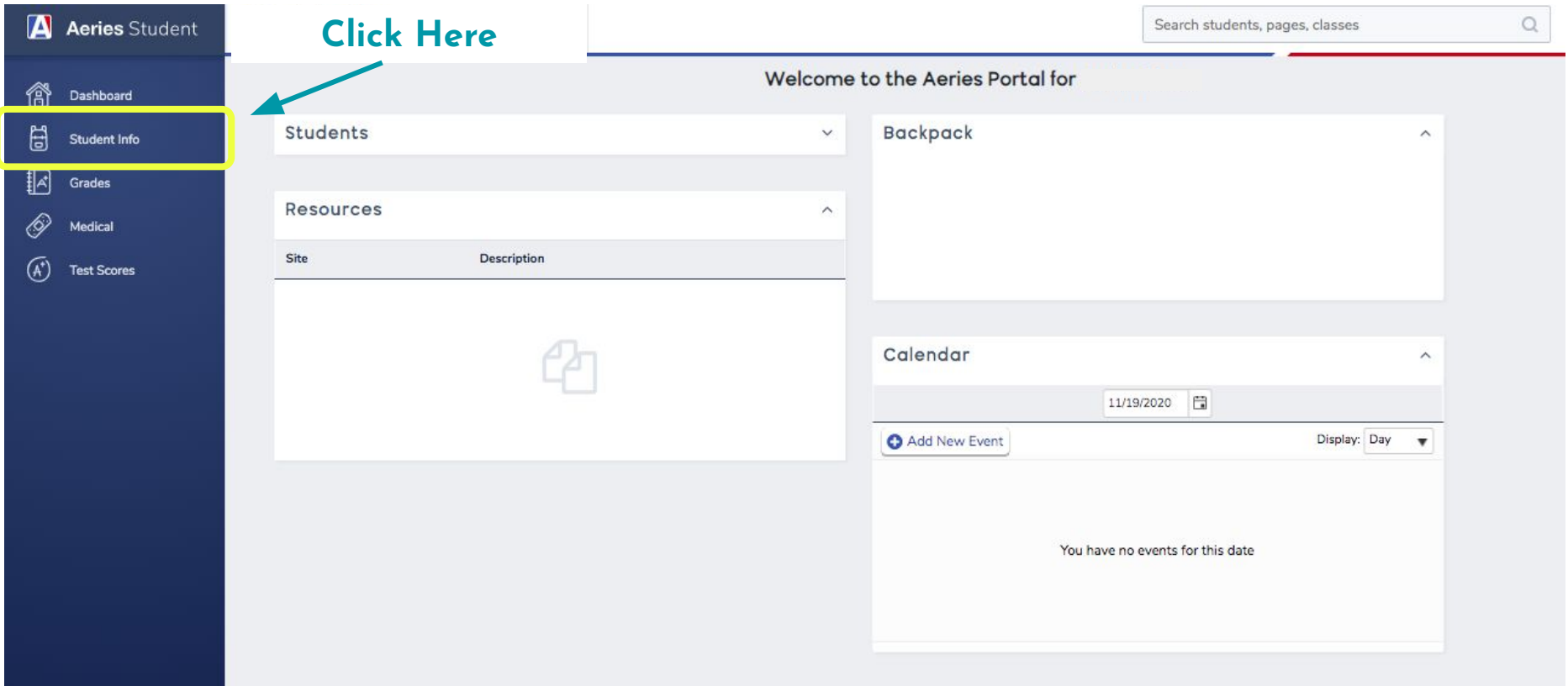

Once signed in, click on the tab on the left titled “Student Info”

# Click Here

< Student Info

Profile

Demographics

Contacts

Data Confirmation

Authorizations

Student Google Account

Home Technology

General Contact Add'l info Flags Programs 0

Please update information that is no longer valid. Any address changes are subject to approval. A new address verification is required to be completed at the school for all address changes. After saving click the **Confirm and Continue** button to proceed to the next step.

✓ Family Information

Thank you for confirming the student data in the system.

Thank you for confirming the data for your student.

✓ Student

Having accurate information greatly helps the school maintain a healthy and safe learning environment.

✓ Contacts

The San Mateo-Foster City School District offers free and reduced-price meals for children served under the National School Lunch Program and/or School Breakfast Program. For more information and to fill out the online meal application, please go to <http://www.smfcsd.net/en/nutrition-and-school-meals/free-reduced-price-meals.html>

✓ Medical History

Please fill out the form even if you're not sure your child qualifies. In addition to helping your child get vital nutrition during the school day, our free and reduced meal program helps us qualify for supplementary state funding.

✓ Documents

If you have additional students in the San Mateo-Foster City School District and have not yet completed the data confirmation for them, use the **Change Student** dropdown at the top of the page to select another student. If a student is not visible in that list, please contact your child's school.

✓ Authorizations

✓ Final Data Confirmation

Once in Student Info, click on the tab titled "Data Confirmation"

## Click Here

Please update information that is no longer valid. Any address changes are subject to approval. A new address verification is required to be completed at the school for all address changes. After saving click the **Confirm and Continue** button to proceed to the next step.

✓ Family Information

Last Confirmed: 11/15/2020 9:38:41 PM

✓ Student

Please update your address, telephone numbers, email addresses or parent education level if needed. Parent education level is the highest level for the household. If there are no changes to be made or changes have been completed, Click the **Confirm and Continue** button to proceed to the next step.

✓ Contacts

Please note that if you are updating your child's address, the process to do so is not complete until you scan and email new proofs of residence to the school office for verification. The required proofs of residence documents can be found by clicking here.

✓ Medical History

### \*New for 2020-21\*

✓ Documents

The following user input fields have been added to provide the district with important information about the upcoming school year:

✓ Authorizations

**U10 - Stay with my current teacher:** Please select whether you want your child's assignment to Distance Learning or Hybrid Model to be determined by the assignment given to their current teacher. **(Please Note: Selecting "Stay with teacher, whatever they are assigned" will override any selection on the Authorizations page for Instructional Model.)**

✓ Final Data Confirmation

**U11 - Paired Day Preference:** If your child will be attending school in the hybrid partial-day school day instructional model, on which paired days do you prefer your child attend school? **(Please Note: Not all requests will be honored due to the complexities of scheduling)**

Student Demographics

Click on the "Student" tab in the second set of white tabs and then scroll down

## Student Demographics

	Notes
Mailing Address	Changes to this information will NOT be saved in the system. Instead, the new information will be emailed to the school and the school will contact you for additional information.
Residence Address (if different than Mailing Address)	Changes to this information will NOT be saved in the system. Instead, the new information will be emailed to the school and the school will contact you for additional information.
Primary Phone	
Correspondence Language	Letters and Report Cards sent home from the school will be sent in this language. Not all languages listed are supported by the district.
Parent Highest Education Level	
Ethnicity?	
Race(s)	
U10	
Paired Day Preference	
Birth City	
Birth State	
Birth Country	
<a href="#">Change</a>	

Click Here

Click "Change" to begin confirming your selection



**Do not ignore any of the  
following fields**



Student Demographics		Notes
Mailing Address	<input type="text"/> City: <input type="text"/> State: <input type="text"/> Zip: <input type="text"/> - <input type="text"/>	Changes to this information will NOT be saved in the system. Instead, the new information will be emailed to the school and the school will contact you for additional information.
Residence Address (if different than Mailing Address)	<input type="text"/> City: <input type="text"/> State: <input type="text"/> Zip: <input type="text"/> - <input type="text"/>	Changes to this information will NOT be saved in the system. Instead, the new information will be emailed to the school and the school will contact you for additional information.
Primary Phone	<input type="text"/>	
Correspondence Language	English	Letters and Report Cards sent home from the school will be sent in this language. Not all languages listed are supported by the district.
Parent Highest Education Level	Unknown	
Ethnicity?	Is this student Hispanic or Latino? <input type="checkbox"/> Yes <input type="checkbox"/> No	
Race(s)	What is the race of this student? You may select up to five. <input type="checkbox"/> American Indian or Alaskan Native <input type="checkbox"/> Chinese <input type="checkbox"/> Japanese <input type="checkbox"/> Korean <input type="checkbox"/> Vietnamese <input type="checkbox"/> Asian Indian <input type="checkbox"/> Laotian	

1 - Note that fields in “Student Demographics” are now able to be changed

2 - Scroll down and click on “U10.” You MUST select either “Parent/Guardian chooses assignment” or “Stay with Teacher, whatever they are assigned.”

- Laotian
- Cambodian
- Hmong
- Other Asian
- Hawaiian
- Guamanian
- Samoan
- Tahitian
- Other Pacific Islander
- Filipino
- Black or African American
- White
- Intentionally Left Blank

**Additional Definitions:**

**American Indian or Alaskan Native:** A person having origins in any of the original peoples of North and South America (including Central America), and who maintains tribal affiliation or community attachment.

**Black or African American:** A person having origins in any of the black racial groups of Africa.

**White:** A person having origins in any of the original peoples of Europe, the Middle East, or North Africa.

U10

Paired Day Preference

people of Europe, the Middle East, or North Africa

- ✓ Parent/Guardian chooses assignment
- Stay with Teacher, whatever they are assigned

U10

Parent/Guardian chooses assignment

Paired Day Preference

San Francisco

Birth City

California

Birth State

United States Of America

Birth Country

Save Cancel

Paired Day Preference

- ✓ Monday & Tuesday
- No Preference
- Thursday & Friday

3 - If you have selected or plan to select “Hybrid” as an assignment, you can choose which days you prefer

	<input type="checkbox"/> Laotian	
	<input type="checkbox"/> Cambodian	
	<input type="checkbox"/> Hmong	
	<input type="checkbox"/> Other Asian	
	<input type="checkbox"/> Hawaiian	
	<input type="checkbox"/> Guamanian	
	<input type="checkbox"/> Samoan	
	<input type="checkbox"/> Tahitian	
	<input type="checkbox"/> Other Pacific Islander	
	<input type="checkbox"/> Filipino	
	<input type="checkbox"/> Black or African American	
	<input type="checkbox"/> White	
	<input type="checkbox"/> Intentionally Left Blank	
	<b>Additional Definitions:</b>	
	<b>American Indian or Alaskan Native:</b> A person having origins in any of the original peoples of North and South America (including Central America), and who maintains tribal affiliation or community attachment.	
	<b>Black or African American:</b> A person having origins in any of the black racial groups of Africa.	
	<b>White:</b> A person having origins in any of the original peoples of Europe, the Middle East, or North Africa.	
U10	Parent/Guardian chooses assignment	
Paired Day Preference		
Birth City	San Francisco	
Birth State	California	
Birth Country	United States Of America	
	<input type="button" value="Save"/> <input type="button" value="Cancel"/>	

Make sure to scroll down and click “Save”



**BE SURE YOU SCROLL  
DOWN AND CLICK  
“SAVE”**

✓ Family Information

✓ Student

✓ Contacts

✓ Medical History

✓ Documents

✓ Authorizations

✓ Final Data Confirmation

Last Confirmed: 11/15/2020 9:51:23 PM

Please check the box that best applies to your student for each item, then **SAVE**. Click the **Confirm and Continue** button to proceed to the next step

Click Here

## Authorizations and Prohibitions

Description	Status																																	
<b>Spring Instructional Model Options</b> <p>There are two instructional models that Elementary parents may choose from:</p> <ol style="list-style-type: none"><li>1. Full-Time Distance Learning</li><li>2. Hybrid Partial-Day/Partial Distance Learning Instruction</li></ol> <p>Detailed information regarding the structure of each plan is provided in the following link:</p> <p>Fall Reopening Plan for SMFCSD</p> <p><b>PLEASE NOTE:</b> The Hybrid Partial-Day Model is only available in grades TK-5. If your child is entering 6th, 7th, or 8th grade, the selection here will have no impact on their instruction, they will be enrolled in Full Time Distance Learning. If no response is recorded by <b>11:59PM on Sunday, November 22</b> your child's selection will be the default model for their grade level as follows:</p>																																		
<table border="1"><thead><tr><th>Grade Level</th><th>TK</th><th>K</th><th>1</th><th>2</th><th>3</th><th>4</th><th>5</th><th>6</th><th>7</th><th>8</th></tr></thead><tbody><tr><td>Hybrid Partial-Day Instruction</td><td>✓</td><td>✓</td><td>✓</td><td>✓</td><td>✓</td><td>✓</td><td>✓</td><td></td><td></td><td></td></tr><tr><td>Full Time Distance Learning</td><td></td><td></td><td></td><td></td><td></td><td></td><td></td><td>✓</td><td>✓</td><td>✓</td></tr></tbody></table>	Grade Level	TK	K	1	2	3	4	5	6	7	8	Hybrid Partial-Day Instruction	✓	✓	✓	✓	✓	✓	✓				Full Time Distance Learning								✓	✓	✓	<input checked="" type="checkbox"/> Full Time Distance Learning <input type="checkbox"/> Hybrid Partial-Day School Day
Grade Level	TK	K	1	2	3	4	5	6	7	8																								
Hybrid Partial-Day Instruction	✓	✓	✓	✓	✓	✓	✓																											
Full Time Distance Learning								✓	✓	✓																								

If you selected "Stay with teacher, whatever they are assigned" in the U10 field on the Student page, your child's assignment will be determined by the assignment given to their current teacher and will override the selection made here.

Confirmation is equivalent to an electronic signature.

Click on the white "Authorizations" tab and select the learning model of your choice

Full Time Distance Learning  Hybrid Partial-Day School Day

\*This only applies if you have previously selected "Parent/Guardian chooses assignment," not if you've chosen to stay with your current teacher



**SCROLL DOWN AND  
CLICK “SAVE”**

## Authorizations

[Click Here](#)

General Contact Addtl Info

### Authorizations / Prohibitions

Date	Type	Status Date	End Date	Status	Code
7/26/2020	1 - Prog Participation Authorization or Prohibition	7/26/2020	11/14/2020	Received-Yes	Media Consent
11/15/2020	1 - Prog Participation Authorization or Prohibition	11/15/2020		Received-No	Media Consent
7/26/2020	1 - Prog Participation Authorization or Prohibition	7/26/2020		Received-Yes	Parent Permission to Seek Medical Care
7/26/2020	1 - Prog Participation Authorization or Prohibition	7/26/2020	11/14/2020	Received-No	Spring Instructional Model Options
11/15/2020	1 - Prog Participation Authorization or Prohibition	11/15/2020	11/18/2020	Received-Yes	Spring Instructional Model Options
11/19/2020	1 - Prog Participation Authorization or Prohibition	11/19/2020		Received-Yes	Spring Instructional Model Options
7/26/2020	1 - Prog Participation Authorization or Prohibition	7/26/2020	11/14/2020	Received-Yes	Directory Information Release
11/15/2020	1 - Prog Participation Authorization or Prohibition	11/15/2020		Received-No	Directory Information Release

To check what you have selected and what is current in Aeries, click on the blue “Authorizations” tab from the first set of tabs (refer to next slide).

## Authorizations

[Click Here](#)

General Contact Addtl Info

### Authorizations / Prohibitions

Date	Type	Status Date	End Date	Status	Code
7/26/2020	1 - Prog Participation Authorization or Prohibition	7/26/2020	11/14/2020	Received-Yes	Media Consent
11/15/2020	1 - Prog Participation Authorization or Prohibition	11/15/2020		Received-No	Media Consent
7/26/2020	1 - Prog Participation Authorization or Prohibition	7/26/2020		Received-Yes	Parent Permission to Seek Medical Care
7/26/2020	1 - Prog Participation Authorization or Prohibition	7/26/2020	11/14/2020	Received-No	Spring Instructional Model Options
11/15/2020	1 - Prog Participation Authorization or Prohibition	11/15/2020	11/18/2020	Received-Yes	Spring Instructional Model Options
11/19/2020	1 - Prog Participation Authorization or Prohibition	11/19/2020		Received-Yes	Spring Instructional Model Options
7/26/2020	1 - Prog Participation Authorization or Prohibition	7/26/2020	11/14/2020	Received-Yes	Directory Information Release
11/15/2020	1 - Prog Participation Authorization or Prohibition	11/15/2020		Received-No	Directory Information Release

Look for “Spring Instructional Model Options.” “Status Date” refers to when the selection was originally made or updated. It will only change if you selected a different learning model from the one you selected in Spring. “**Received - Yes**” indicates Full Time Distance Learning and “**Received - No**” indicates Hybrid.



***“Received - Yes”*** indicates Full Time Distance Learning

***“Received - No”*** indicates Hybrid.





**Thank you for taking the time to go back in the Parent Portal to confirm we have the most updated selection for your student/s. We hope this makes your choice easier to confirm and that you feel assured that what you have chosen is what the district and the school has in our records.**

**Go Jaguars!**